

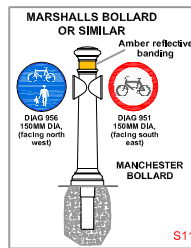

Signs mounted on Manchester bollards

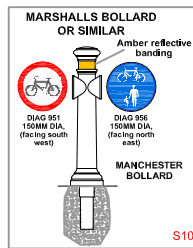
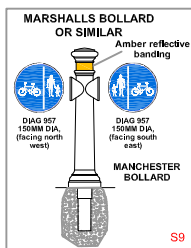
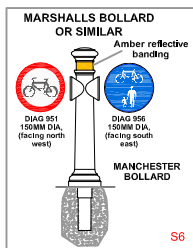
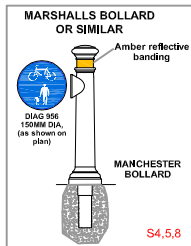
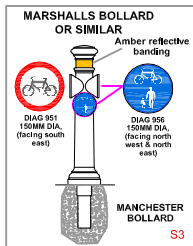
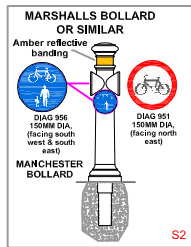
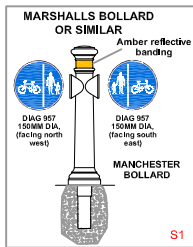

Note.

- Proposed markings & civils work
- Existing markings/tactile pavings to be removed
- Existing location of signal/post to be removed or relocated
- New location of signal/post

Refer to the plan for orientation of the signs when erecting the bollards

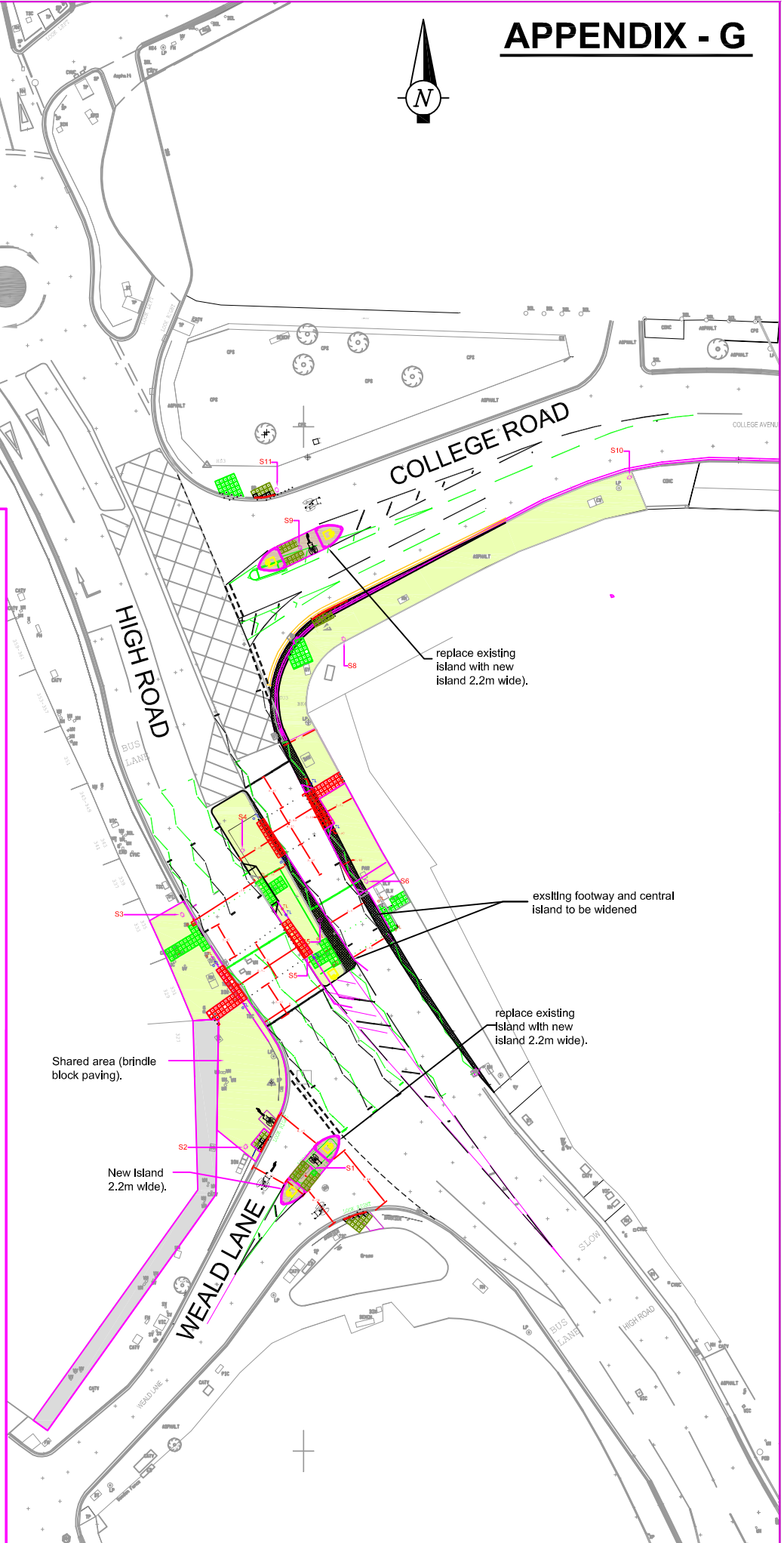

NOTES:

		Project LONG ELMES CYCLE SCHEME		Scale N.T.S.	Drawn SAF	Checked BP
Community & Environment TRANSPORTATION		Title SHARED USE TOUCAN CROSSING		Drawing no T/DWG/000902/A		
P.O. Box 38, Civic Centre, Harrow, Middlesex, HA1 2XA Tel: 020 8843 5611 Fax: 020 8420 9611		Date 19-08-2015		Autocad file TPR/0132/Long Elmes		